

STORM A4 - S59

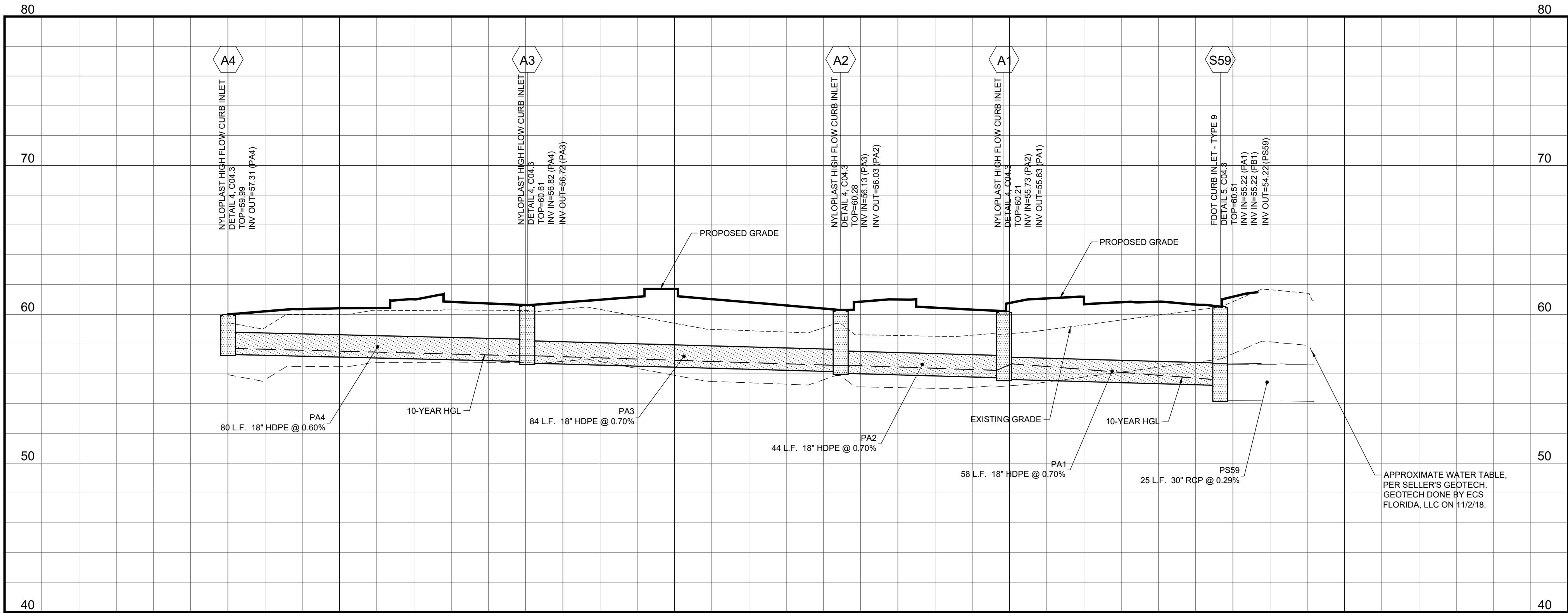

HORIZONTAL SCALE: 1"=20'
VERTICAL SCALE: 1"=5'

STORM B2 - S59

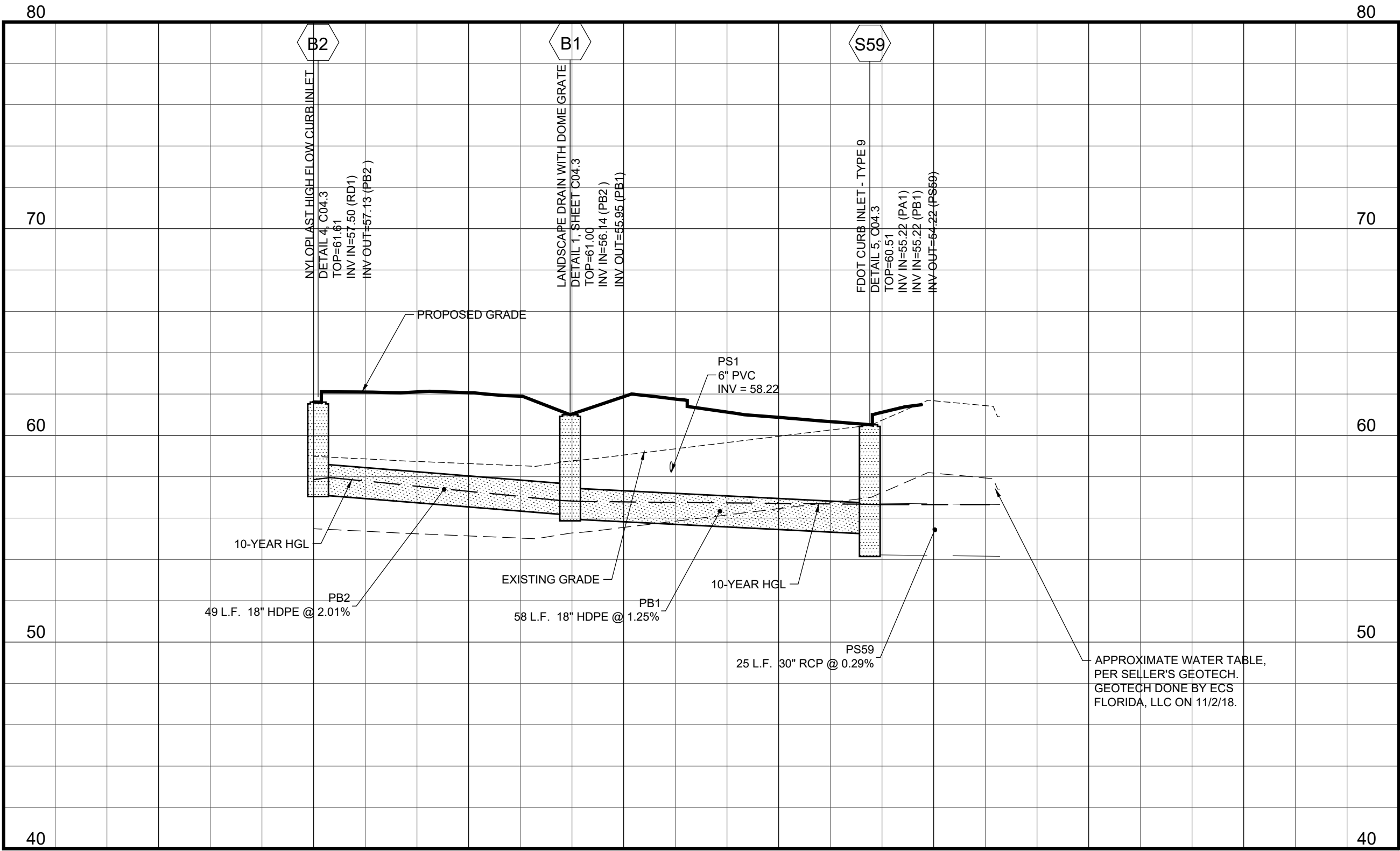

HORIZONTAL SCALE: 1"=20'
VERTICAL SCALE: 1"=5'

PROFILE NOTES

1. REFER TO DETAIL 2 ON SHEET C04.4 FOR BACKFILL AND COMPACTION REQUIREMENTS.
2. STORM DRAIN AND SANITARY SEWER LENGTHS ARE MEASURED FROM CENTER LINE OF STRUCTURE TO CENTERLINE OF STRUCTURE OR FACE OF HEADWALL.
3. ALL PIPE LENGTHS SHOWN ARE ROUNDED TO THE NEAREST FOOT.
4. ALL STORM DRAIN PIPING SHALL BE TRENCHED, BEDDED AND BACK FILLED ACCORDING WITH DETAIL 2 ON SHEET C04.4 UNLESS SPECIFICALLY NOTED OTHERWISE.
5. ALL SANITARY SEWER PIPING SHALL BE TRENCHED, BEDDED AND BACK FILLED ACCORDING WITH DETAIL 2 ON SHEET C04.4 UNLESS SPECIFICALLY NOTED OTHERWISE.
6. UNFORESEEN SUBSURFACE CONDITIONS SHALL BE BROUGHT TO THE OWNER'S AND ENGINEER'S ATTENTION IMMEDIATELY IMPLEMENTATION OF CORRECTIVE BEDDING MEASURES WITHOUT THE OWNER'S APPROVAL SHALL BE AT THE CONTRACTOR'S OWN RISK AND AT NO ADDITIONAL COMPENSATION.
7. EXISTING GRADES SHOWN ARE APPROXIMATE AND DO NOT REFLECT TOP SOIL REMOVAL, CLEARING, AND GRUBBING OPERATIONS. THE CONTRACTOR SHALL ASCERTAIN FOR HIMSELF THE EXTENT OF DISTURBANCE FOR THESE ACTIVITIES.
8. THE CONTRACTOR SHALL REFERENCE THE GEOTECHNICAL REPORT PREPARED FOR THE OWNER FOR SUBSURFACE CONDITIONS. THE GEOTECHNICAL REPORT IS NOT A PART OF THE CONTRACT DOCUMENTS.
9. EXCAVATIONS FOR STRUCTURES SHALL BE TAKEN AS A TRENCHING EXCAVATION WITHOUT FURTHER COMPENSATION.
10. SEE SHEET C01.1 FOR GENERAL NOTES.

10-YEAR INLET CALCULATIONS

Line No	Inlet ID	Q = CIA				Junc Type	Curb Inlet		Grate Inlet				Gutter						Inlet			Byo Line No
		Q	Q	Q	Q		Ht	L	Area	L	W	So	W	Sw	Sx	n	Depth	Spread	Depth	Spread	Depth	
		(cfs)	(cfs)	(cfs)	(cfs)		(in)	(ft)	(sqft)	(ft)	(ft)	(in)	(ft)	(ft)	(ft)		(ft)	(ft)	(ft)	(ft)	(in)	
11	A4	1.09	0.00	1.09	3.00	Comb	5.7	2.90	1.07	2.90	1.40	Sag	1.5c	0.083	0.024	0.000	0.22	5.57	0.22	5.57	0.0	Off
10	A3	0.61	0.00	0.61	3.00	Comb	5.7	2.90	1.07	2.90	1.40	Sag	1.5c	0.083	0.027	0.000	0.17	3.22	0.17	3.22	0.0	Off
9	A2	0.38	0.00	0.38	3.00	Comb	5.7	2.90	1.07	2.90	1.40	Sag	1.5c	0.083	0.025	0.000	0.14	2.15	0.14	2.15	0.0	Off
8	A1	0.49	0.00	0.49	3.00	Comb	5.7	2.90	1.07	2.90	1.40	Sag	1.5c	0.083	0.040	0.000	0.16	2.28	0.16	2.28	0.0	Off
7	Null Structure	0.18	0.00	0.00	3.18	None	0.0	0.00	0.00	0.00	0.00	Sag	0.0c	0.000	0.000	0.000	0.00	0.00	0.00	0.00	0.0	Off
6	Null Structure	0.18	0.00	0.00	3.18	None	0.0	0.00	0.00	0.00	0.00	Sag	0.0c	0.000	0.000	0.000	0.00	0.00	0.00	0.00	0.0	Off
5	Structure - (67)	0.01*	0.00	0.00	3.01	None	0.0	0.00	0.00	0.00	0.00	Sag	0.0c	0.000	0.000	0.000	0.00	0.00	0.00	0.00	0.0	Off
4	Structure - (68)	0.01*	0.00	0.00	3.01	None	0.0	0.00	0.00	0.00	0.00	Sag	0.0c	0.000	0.000	0.000	0.00	0.00	0.00	0.00	0.0	Off
3	B2	0.79	0.00	0.79	3.00	Comb	5.7	2.90	1.07	2.90	1.40	Sag	1.5c	0.083	0.016	0.000	0.19	5.65	0.19	5.65	0.0	Off
2	S59	0.11	0.00	0.11	3.00	DrGr	0.0	0.00	1.00	1.00	1.00	Sag	1.5c	0.062	0.062	0.000	0.04	2.87	0.04	2.87	0.0	Off
1	S59	1.26	0.00	1.26	3.00	Comb	4.0	5.92	2.10	5.92	1.50	Sag	1.5c	0.083	0.024	0.000	0.19	4.34	0.19	4.34	0.0	Off

Project File: 200071.sdm Number of lines: 11 Run Date: 12/7/2020

NOTES: Inlet N-Values = 0.016; Intensity = 53.44 / (Inlet time + 6.50) ^ 0.70; Return period = 10 Yrs; * Indicates Known Q added All curb inlets are throat.

10-YEAR PIPE CALCULATIONS

Station	Len	Drng Area	Rnoff	Area x C		Tc	Rain	Total	Cap	Vel	Pipe	Invert Elev		HGL Elev		Grnd / Rim Elev		Line ID					
Line	To		Incr	Total	Incr	Total	Inlet	Total	Full		Size	Slope	Dn	Up	Dn	Up	Dn	Up					
	Line		(ac)	(ac)			(min)	(min)	(in/hr)	(cfs)	(in)	(%)	(ft)	(ft)	(ft)	(ft)	(ft)	(ft)					
11	10		80.426	0.19	0.15	0.92	0.17	0.17	15.0	15.0	6.3	1.09	8.88	3.01	18	0.61	56.82	57.31	57.21	57.70	60.60	59.95	PA4
10	9		84.208	0.11	0.30	0.89	0.10	0.27	15.0	15.4	6.2	1.68	9.52	3.66	18	0.70	56.13	56.72	56.57	57.21	60.25	60.60	PA3
9	8		43.869	0.07	0.37	0.86	0.06	0.33	15.0	15.6	6.1	2.03	9.41	3.77	18	0.68	55.73	56.03	56.23	56.57	60.20	60.25	PA2
8	1		58.085	0.10	0.47	0.78	0.08	0.41	15.0	16.0	6.1	2.49	9.56	2.61	18	0.71	55.22	55.63	56.67	56.23	60.50	60.20	PA1
7	4		12.580	0.03	0.03	0.95	0.03	0.03	15.0	15.0	6.3	0.18	0.86	1.86	6	1.99	58.17	58.42	58.47	58.63	62.05	62.80	RD2
6	5		12.580	0.03	0.03	0.95	0.03	0.03	15.0	15.0	6.3	0.18	0.86	2.23	6	1.99	58.61	58.86	58.83	59.07	62.25	62.80	RD4
5	4		22.056	0.01	0.04	0.01	0.00	0.03	15.0	15.1	6.2	0.19	0.86	1.92	6	1.99	58.17	58.61	58.47	58.83	62.05	62.25	RD3
4	3		33.234	0.01	0.06	0.01	0.00	0.06	15.0	15.2	6.2	0.37	0.86	2.45	6	1.99	57.50	58.16	57.96	58.47	61.60	62.05	RD1
3	2		49.012	0.15	0.23	0.84	0.13	0.18	15.0	15.5	6.2	1.15	16.09	4.15	18	2.00	56.58	57.56	56.85	57.96	61.00	61.60	PB2
2	1		58.004	0.04	0.27	0.42	0.02	0.20	15.0	15.7	6.1	1.24	16.09	1.91	18	2.00	55.22	56.38	56.67	56.80	60.50	61.00	PB1
1	End		25.144	0.24	0.98	0.84	0.20	0.81	15.0	16.4	6.0	4.88	23.44	1.00	30	0.28	54.15	54.22	56.65	56.65	58.42	60.50	PS56

Project File: 200071.sdm

Number of lines: 11

Run Date: 12/7/2020

NOTES: Intensity = 53.44 / (inlet time + 6.50) ^ 0.70; Return period = 10 Yrs; 10 : c = cir e = ellip b = box



PANDA EXPRESS, INC.
1683 WALNUT GROVE AVE.
ROSEMead, CALIFORNIA 91770
TELEPHONE: 626.799.9898
FACSIMILE: 626.372.8288

All ideas, designs, arrangement and plans indicated or represented by this drawing are the property of Panda Express Inc. and were created for use on this specific project. None of these ideas, designs, arrangements or plans may be used by or disclosed to any person, firm, or corporation without the written permission of Panda Express Inc.

REVISIONS:

C1 1ST COUNTY COMMENTS 04/05/2021
C2 2ND COUNTY COMMENTS 06/04/2021

ISSUE DATE:

ALT. STANDARDS 12/17/2020
PRELIMINARY SITE PLAN 01/12/2021
COUNTY COMMENTS 04/05/2021
ISSUE FOR BID 06/04/2021

DRAWN BY: INGENIUM

PANDA PROJECT #: D8135
PANDA STORE #:
ARCH PROJECT #:



PROFILES II

C04.6