

CORNER RECORD

Agency Index

BK 113 PG 51

Document Number

CR 11662

City of EDEN TOWNSHIP

County of ALAMEDA, California

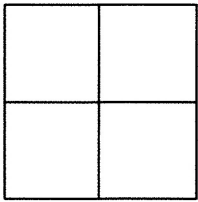
Brief Legal Description WELL MONUMENT LOCATED WITHIN BLOSSOM WAY
AT THE INTERSECTION OF WESTERN BLVD

CORNER TYPE

| | | | |
|-------------------|--------------------------|----------|-------------------------------------|
| Government Corner | <input type="checkbox"/> | Control | <input checked="" type="checkbox"/> |
| Meander | <input type="checkbox"/> | Property | <input type="checkbox"/> |
| Rancho | <input type="checkbox"/> | Other | <input type="checkbox"/> |

Date of Survey 6/26/18

COORDINATES (Optional)

N. 2073735 ± E. 6098268 ±

Elevation

Units Metric ☐ U.S. Survey Foot ☐

Horizontal Datum

Zone Epoch Date

Vertical Datum

☐ Complies with Public Resources Code §§8801-8819☐ Complies with Public Resources Code §§8890-8902PLS Act Ref: ☐ 8765(d) ☒ 8771 ☐ 8773 ☐ Other:

| | | | | |
|----------------------|---|--|--|--|
| Corner/ Monument: | <input checked="" type="checkbox"/> Left as found | <input type="checkbox"/> Established | <input type="checkbox"/> Rebuilt | <input checked="" type="checkbox"/> Pre-Construction |
| | <input type="checkbox"/> Found and tagged | <input type="checkbox"/> Reestablished | <input checked="" type="checkbox"/> Referenced | <input type="checkbox"/> Post-Construction |

Narrative of corner identified and monument as found, set, reset, replaced, or removed:

☐ See sheet #2 for description(s) :

FOUND BRASS DISK WITH NIPPLE IN MONUMENT WELL "ALAMEDA COUNTY SURVEYOR BLO WEST 1960"

FOUND AND SET POINTS AS SHOWN ON PAGE 2.

THIS POINT WAS REFERENCED PRIOR TO A CONSTRUCTION PROJECT IN THE VICINITY.

THE TIES SHOWN HEREON ARE FOR THE PURPOSE OF PERPETUATING FOUND MONUMENTATION.

NO CLAIM IS MADE AS TO THE RELATIONSHIP OF THE POINTS OR LINES SHOWN HEREON TO TRUE
BOUNDARY LOCATION.

SURVEYOR'S STATEMENT

This Corner Record was prepared by me or under my direction in conformance with

the Professional Land Surveyors' Act on JUNE 29, 2018.

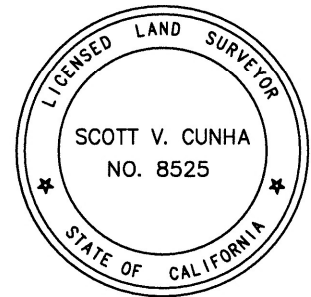
Signed Scott V Cunha P.L.S. or R.C.E. No. LS 8525
SCOTT V. CUNHA

COUNTY SURVEYOR'S STATEMENT

This Corner Record was received 3 JULY 2018

and examined and filed 12 SEPTEMBER 2018

Signed Michael Rubner P.L.S. or R.C.E. No. 6843Title COUNTY SURVEYOR

County Surveyor's Comment

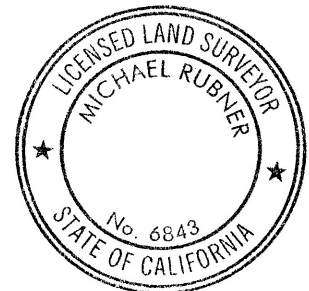

SPEC-2356-Pre

SCALE: 1"=30'

LEGEND

- FOUND BRASS DISC WITH NIPPLE IN MONUMENT WELL
- ⊗ SET CUT CROSS IN WALK
- ✕ SET CUT CROSS IN CURB
- ✕ SET CUT CROSS IN (E) LIGHT POLE BASE
- SET REBAR & CAP STAMPED "CEI RP"
- AA##A# ALAMEDA COUNTY MONUMENT ID
- 19592 REFERENCE STREET ADDRESS

